

SC10CL LBP/MBP Compressor R404A/R507 220-240V 50Hz

Data Sheet (Replaces CF.54.A1.02)

General

Compressor	SC10CL
Code number	104L2523

Application

Application	LBP/MBP	
Evaporating temperature range	°C	-35 to -5
Voltage range	V/Hz	198 - 254 /50
Motor type	CSIR	
Max. ambient temperature	°C	38
Comp. cooling at ambient temp.	32°C	F ₂
	38°C	F ₂

Design

Displacement	cm ³	10.29
Oil quantity	cm ³	600
Maximum refrigerant charge	g	1300
Free gas vol. in compressor	cm ³	1410
Weight without electrical equipment	kg	13.1

Motor

Motor size	watt	315
LRA (rated after 4 sec. UL984) HST	A	12.6
Cut-in current HST	A	12.6
Resistance, main and start winding (25°C)	Ω	6.7/11.8
Approvals	EN 60335-2-34	

Dimensions

Height	mm	A	209
		B	203
		B1	183
		B2	100
Suction connector	location/I.D. mm	C	8.2 ±0.09
Process connector	location/I.D. mm	D	6.2 ±0.09
Discharge connector	location/I.D. mm	E	6.2 ±0.09
Compressors on a pallet	pcs.	80	

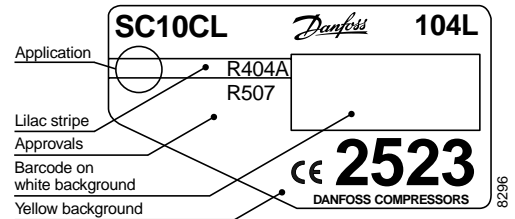

- S = Static cooling normally sufficient
- O = Oil cooling
- F₁ = Fan cooling 1.5 m/s
(compressor compartment temperature equal to ambient temperature)
- F₂ = Fan cooling 3.0 m/s necessary

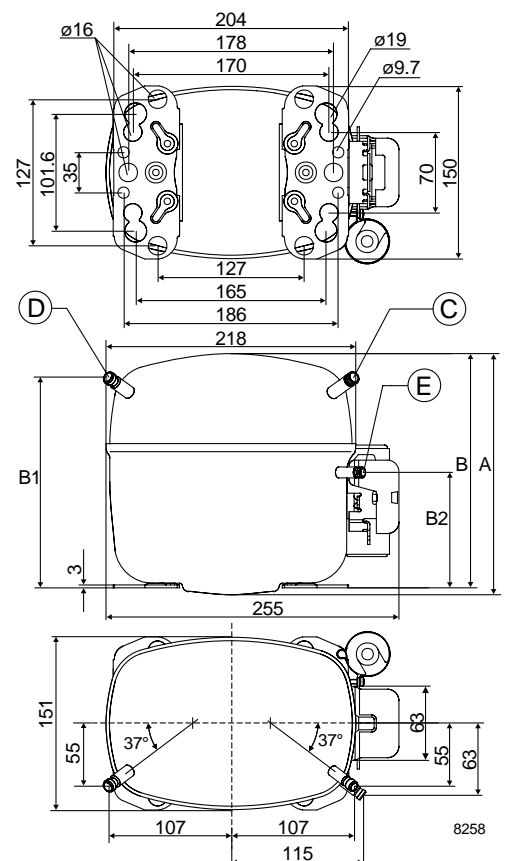

Capacity (EN 12900/CECOMAF)

watt

Comp. °C	-35	-30	-25	-23.3	-20	-15	-10	-5
SC10CL	168	258	365	405	489	634	800	991

Capacity (ASHRAE)

watt

Comp. °C	-35	-30	-25	-23.3	-20	-15	-10	-5
SC10CL	195	300	424	470	569	737	932	1154

Power consumption

watt

Comp. °C	-35	-30	-25	-23.3	-20	-15	-10	-5
SC10CL	243	294	350	370	410	471	530	584

Current consumption

A

Comp. °C	-35	-30	-25	-23.3	-20	-15	-10	-5
SC10CL	1.91	2.05	2.22	2.27	2.39	2.59	2.81	3.04

COP (EN 12900/CECOMAF)

W/W

Comp. °C	-35	-30	-25	-23.3	-20	-15	-10	-5
SC10CL	0.69	0.88	1.04	1.09	1.19	1.35	1.51	1.70

COP (ASHRAE)

W/W

Comp. °C	-35	-30	-25	-23.3	-20	-15	-10	-5
SC10CL	0.80	1.02	1.21	1.27	1.39	1.57	1.76	1.98

Test conditions

Condensing temperature

Ambient and suction gas temp.

Liquid temperature

Fan cooling F₂, 220V 50Hz

EN 12900/CECOMAF

45°C

32°C

45°C

ASHRAE

45°C

32°C

32°C

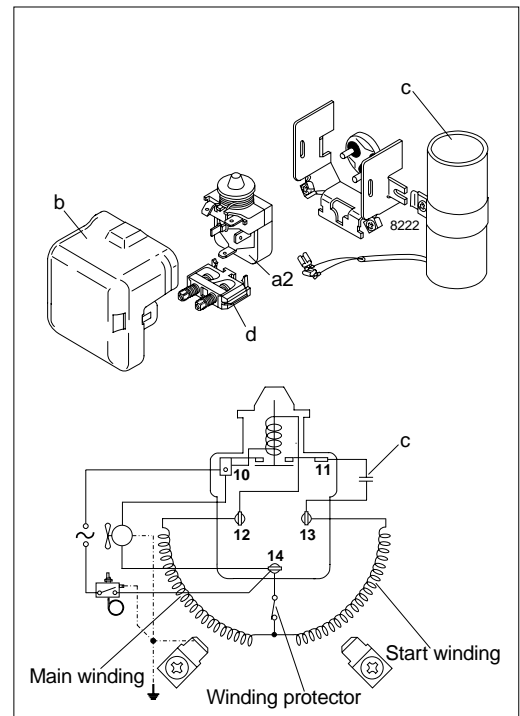

Accessories

Devices	Fig.	SC10CL
Starting relay	a2	117U6003
Cover	b	103N2009
Starting capacitor 80 µF	c	117U5017
Cord relief	d	103N1004
Mounting accessories		
Bolt joint for one compressor		118-1917
Bolt joint in quantities		118-1918
Snap-on in quantities		118-1919